

SECTION B
SCALE 1/8" = 1'-0"
C-100 SHT 3

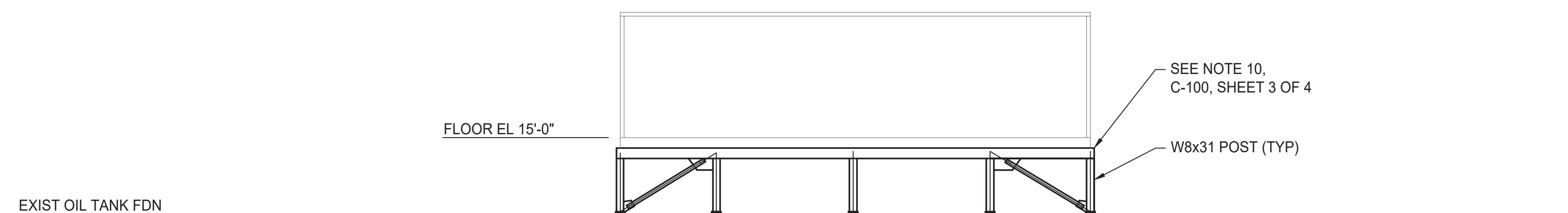

SECTION C
SCALE 1/8" = 1'-0"
C-100 SHT 3

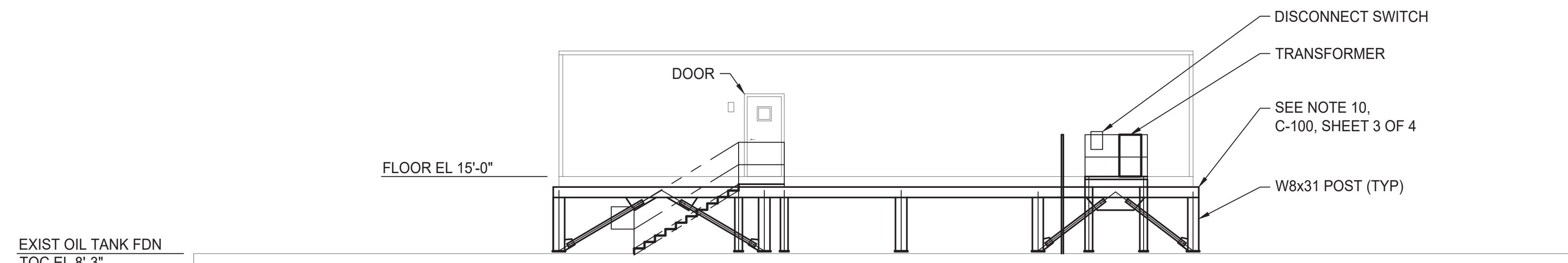

SECTION D
SCALE 1/8" = 1'-0"
C-100 SHT 3

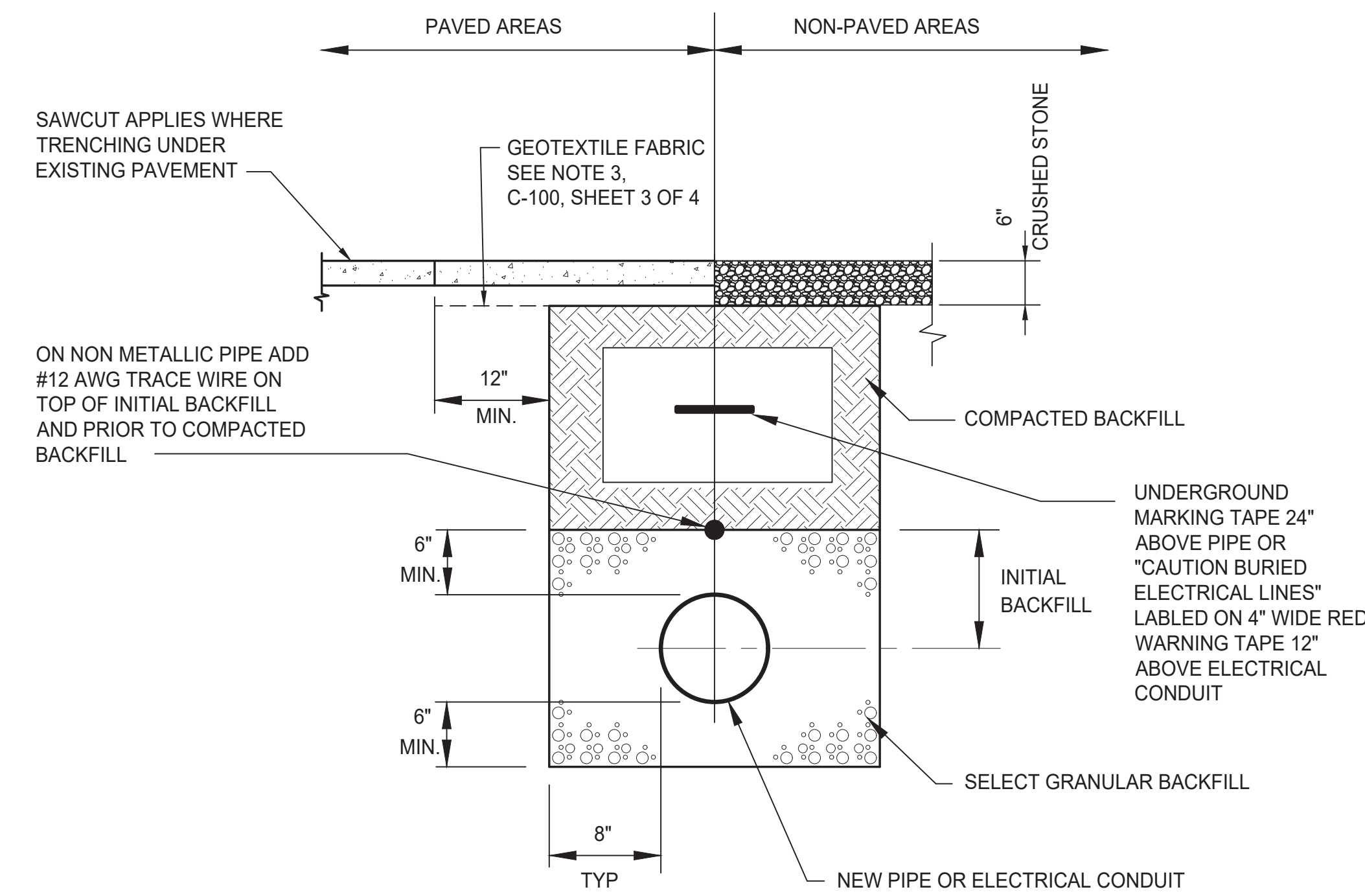

TYPICAL TRENCH DETAIL
NOT TO SCALE

- NOTES:**
- DEPRESS BEDDING AT END BELLS SO THAT PIPE RESTS ON BEDDING ALONG FULL LENGTH.
 - TRENCH EXCAVATION SIDEWALLS SHALL BE VERTICAL FROM 1' ABOVE TOP OF PIPE TO TRENCH BOTTOM. TRENCH SIDEWALLS ABOVE THIS ELEVATION SHALL BE SLOPED AS REQUIRED FOR SOIL STABILITY. CONTRACTOR HAS SOLE RESPONSIBILITY FOR EXCAVATION AND TRENCH SAFETY.
 - WHERE MULTIPLE PIPES OR CONDUITS ARE BURIED IN A COMMON TRENCH, THEY SHALL BE SEPARATED BY A DISTANCE OF AT LEAST ONE DIAMETER OF THE LARGER LINE.

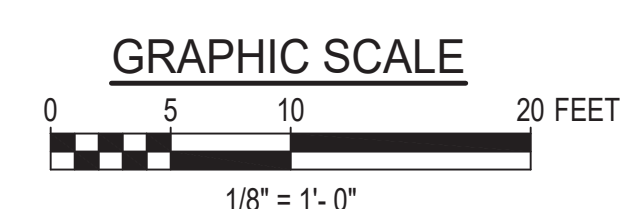
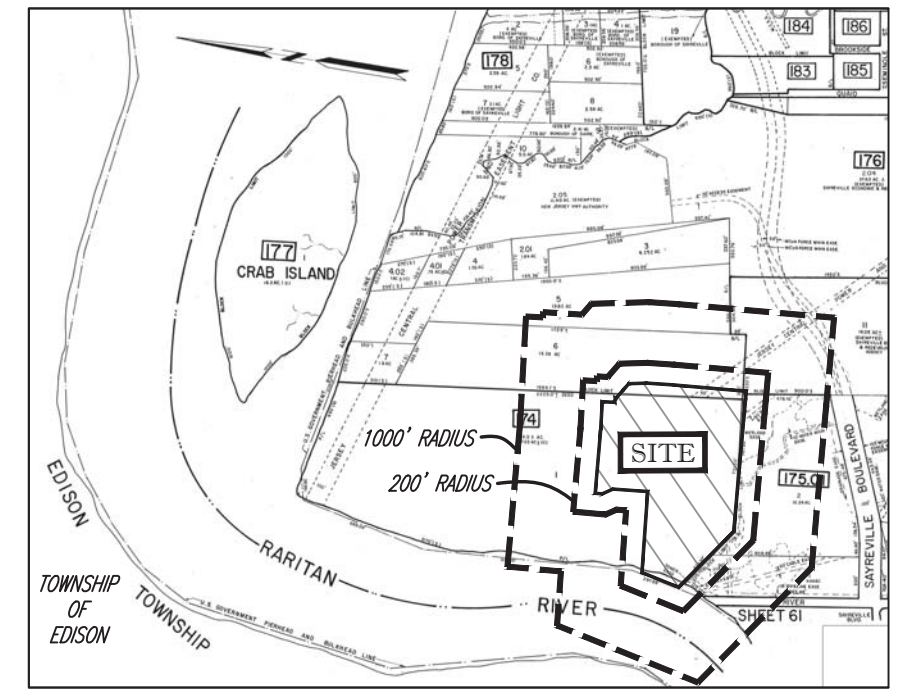
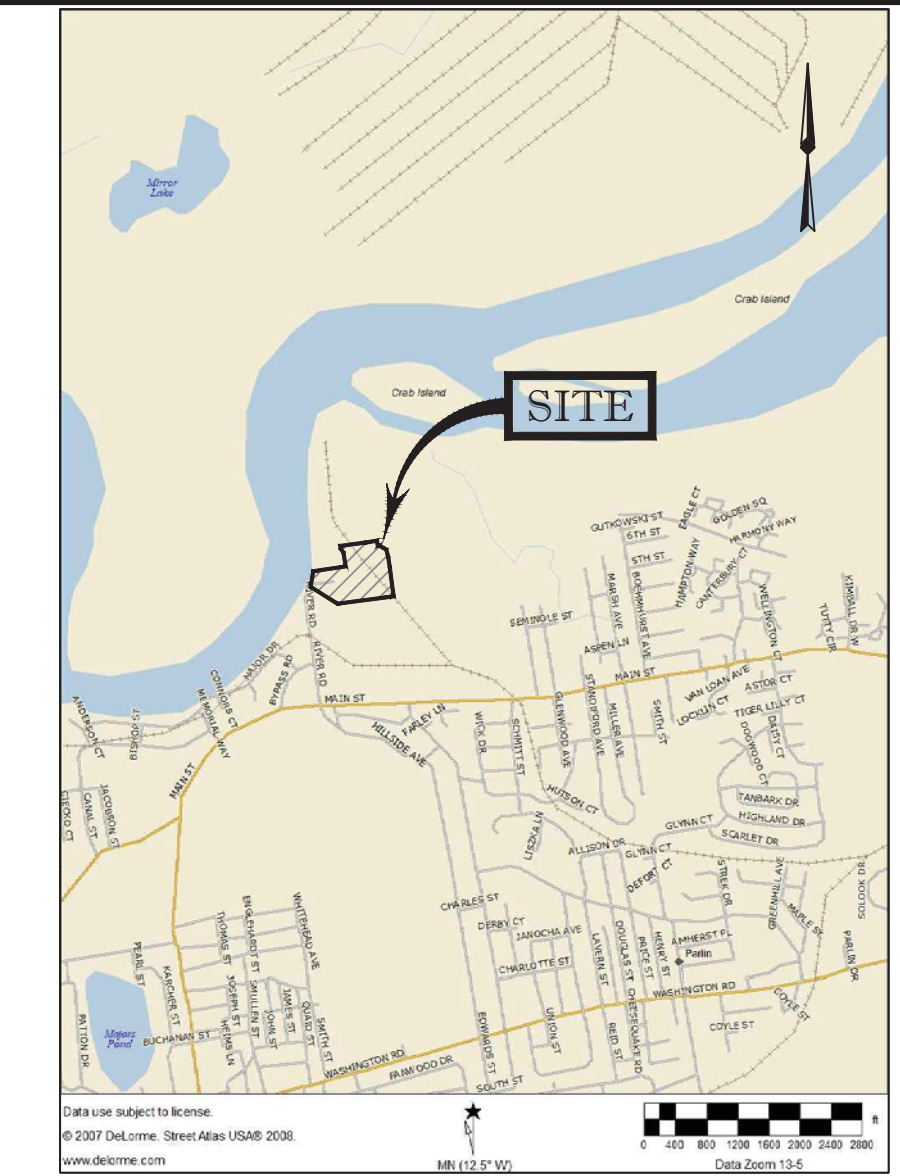

MARTIN C BALLOD
 STATE OF NEW JERSEY
 PROFESSIONAL ENGINEER
 No. GE30509
 Digitally signed by Martin Ballood
 Date: 2020.07.09 15:18:54 -04'00'
 NEW JERSEY PROFESSIONAL ENGINEER NO. GE30509

C-100 SHT 4.DWG

THIS DRAWING WAS PREPARED BY POWER ENGINEERS, INC. FOR A SPECIFIC PROJECT, TAKING INTO CONSIDERATION THE SPECIFIC AND UNIQUE REQUIREMENTS OF THE PROJECT. REUSE OF THIS DRAWING OR ANY INFORMATION CONTAINED IN THIS DRAWING FOR ANY PURPOSE IS PROHIBITED UNLESS WRITTEN PERMISSION FROM BOTH POWER AND POWER'S CLIENT IS GRANTED.

INTER-DISCIPLINE REVIEW						
DISC	ARCH	CIVIL	ELECT	I&C	MECH	STRUCT
DATE	-	-	-	-	-	-
INIT	-	-	-	-	-	-

REV	ISSUED FOR PERMITTING	DATE	DRN	DSGN	CKD	APPD	REFERENCE DRAWINGS
0	ISSUED FOR PERMITTING	7/09/2020	AMW	MB	MB	KC	
	REVISIONS						

DSGN	MB	7/09/2020
DRN	AMW	7/09/2020
CKD	MB	7/09/2020
SCALE:	AS SHOWN	

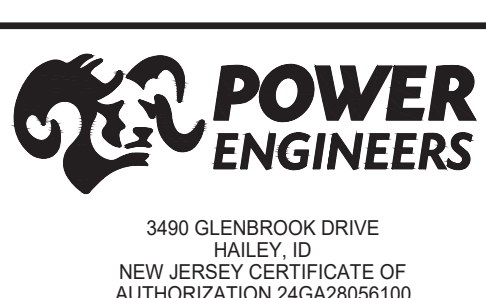

GENON ENERGY SAYREVILLE STATION
 ADMINISTRATION BUILDING
 RELOCATION PROJECT, SAYREVILLE, NJ
 BUILDING ELEVATIONS & TRENCH DETAIL
 PROPOSED LOT A: BLOCK 174, PORTION OF LOT 1, BLOCK 176 & LOT 6

JOB NUMBER	163426	REV	0
DRAWING NUMBER	C-100	4 OF 4	