

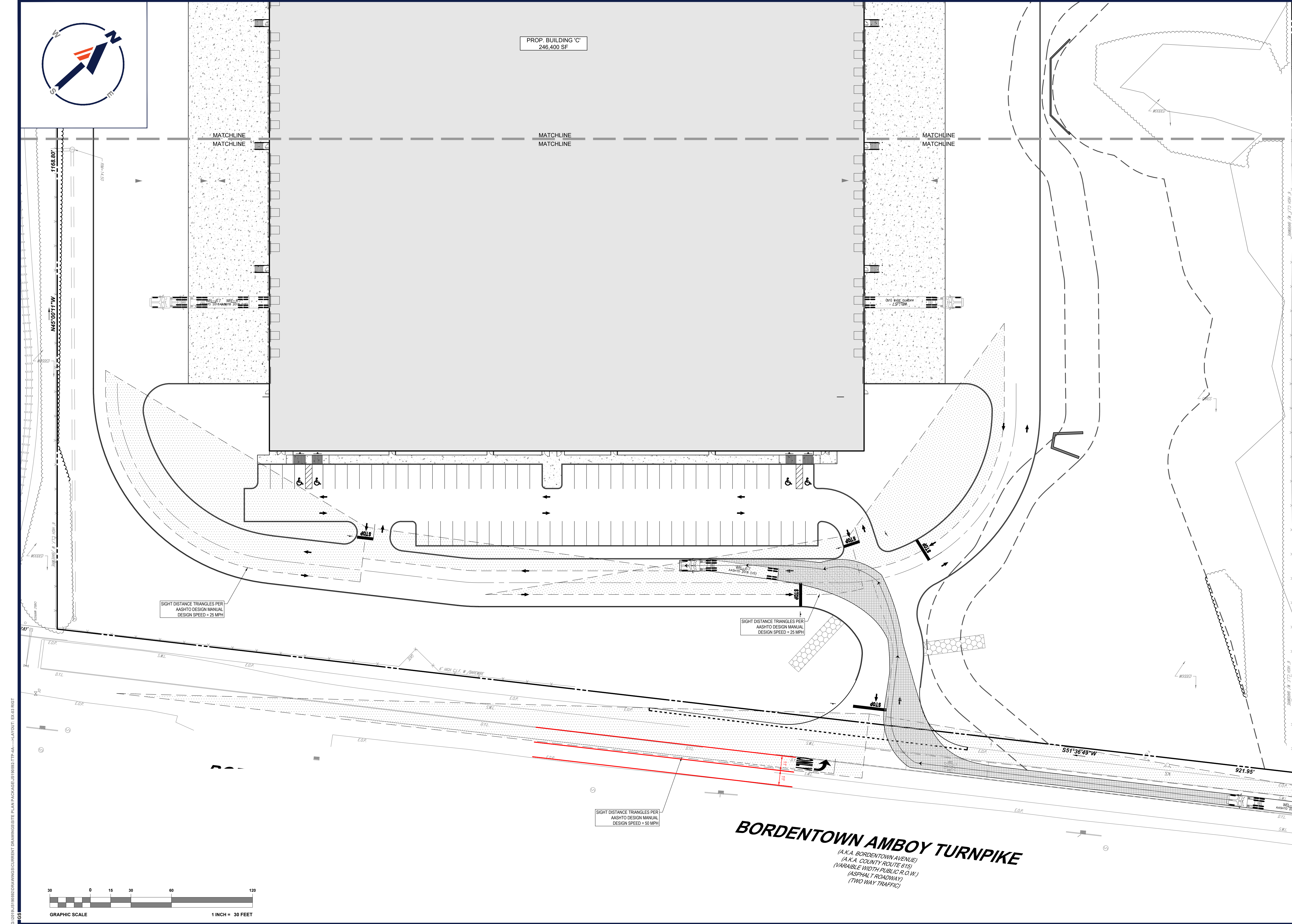

PROP. BUILDING 'C'
246,400 SF

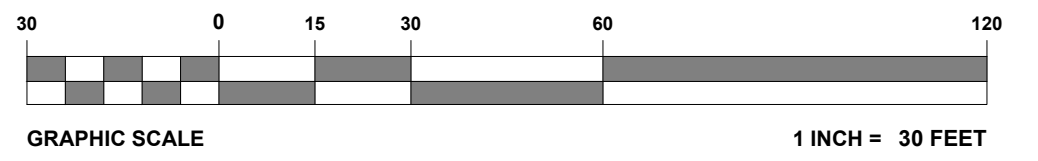

BORDENTOWN AMBOY TURNPIKE
(A.K.A. BORDENTOWN AVENUE)
(A.K.A. COUNTY ROUTE 615)
(VARIABLE WIDTH PUBLIC R.O.W.)
(ASPHALT ROADWAY)
(TWO WAY TRAFFIC)



BOHLER
SITE CIVIL AND CONSULTING ENGINEERING
PROGRAM MANAGEMENT
LANDSCAPE ARCHITECTURE
SUSTAINABLE DESIGN
PERMITTING SERVICES
TRANSPORTATION SERVICES

REVISIONS

REV	DATE	COMMENT	DRAWN BY	CHECKED BY
1	02/05/2021	REV. PER BOROUGH COMMENTS	GBS	BE
2	04/07/2021	REV. PER COUNTY IMPROVEMENTS	GBS	BE
3	07/23/2021	REV. PER COUNTY & BOROUGH COMMENTS	RK	BE
4	10/18/2021	REV. PER CLIENT COMMENTS	MFS	BE

811
Know what's below.
Call before you dig.
NEW JERSEY
YOU MUST CALL 811 BEFORE ANY EXCAVATION
WHETHER IT'S ON PRIVATE OR PUBLIC LAND.
1-800-272-1000
www.nj-811.org

ISSUED FOR MUNICIPAL & AGENCY REVIEW & APPROVAL

THIS DRAWING IS INTENDED FOR MUNICIPAL AND/OR AGENCY REVIEW AND APPROVAL. IT IS NOT INTENDED AS A CONSTRUCTION DOCUMENT UNLESS INDICATED OTHERWISE.

PROJECT No.: JS190592
DRAWN BY: MFS/GBS
CHECKED BY: BE
DATE: 12/07/2020
CAD ID: JS190592-TTP-4A

PRELIMINARY & FINAL MAJOR SITE PLAN
FOR
BORDENTOWN PARK LLC
PROPOSED
WAREHOUSE & SITE IMPROVEMENTS
TAX MAP: 4 | BLK: 14 | LOT: 1
4000 BORDENTOWN AVE
MIDDLESEX COUNTY
SAYREVILLE, NEW JERSEY

BOHLER
BOHLER ENGINEERING NJ, LLC
30 INDEPENDENCE BLVD., SUITE 200
WARREN, NJ 07059
Phone: (908) 685-6300
Fax: (908) 754-4401
www.BohlerEngineering.com
NJ CERT. OF AUTHORIZATION NO. 24GA28161700 & MH6000122

R.L. STREKER
PROFESSIONAL ENGINEER
NEW JERSEY LICENSE No. 45344
NEW YORK LICENSE No. 079514

SHEET TITLE:
RIGHT IN TRUCK TURN EXHIBIT

SHEET NUMBER:
EX-03

REVISION 4 - 10/18/2021

C:\0101\190592\DRAWINGS\CURRENT DRAWINGS\SITE PLAN PACKAGE\190592-TTP-4A-1-LAYOUT-EX-03.RVT