

BLOCK 257  
LOT 3.04



WILL BE KNOWN AS COLLIER ENGINEERING & DESIGN IN 2021  
Customer Loyalty through Client Satisfaction  
www.maserconsulting.com

- Office Locations:
- NEW JERSEY
  - NEW YORK
  - PENNSYLVANIA
  - VIRGINIA
  - FLORIDA
  - NORTH CAROLINA
  - SOUTH CAROLINA
  - NEW MEXICO
  - MARYLAND
  - GEORGIA
  - TEXAS
  - TENNESSEE
  - COLORADO

**811** PROTECT YOURSELF  
ALL STATES REQUIRE NOTIFICATION OF  
DIGITALLY SIGNED OR ANY PERSON  
PREPARING TO DISTURB THE EARTH'S  
SURFACE ANYWHERE IN ANY STATE  
Know what's below.  
Call before you dig.  
FOR STATE SPECIFIC DIRECT PHONE NUMBERS  
VISIT: WWW.CALL811.COM

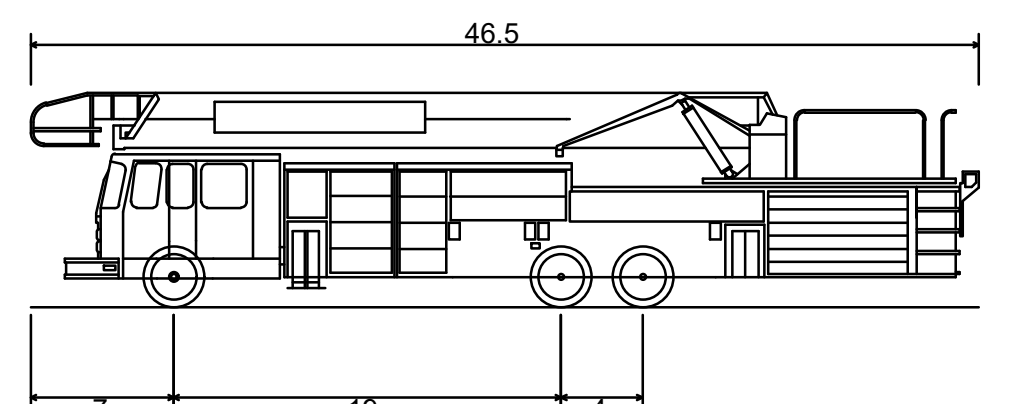
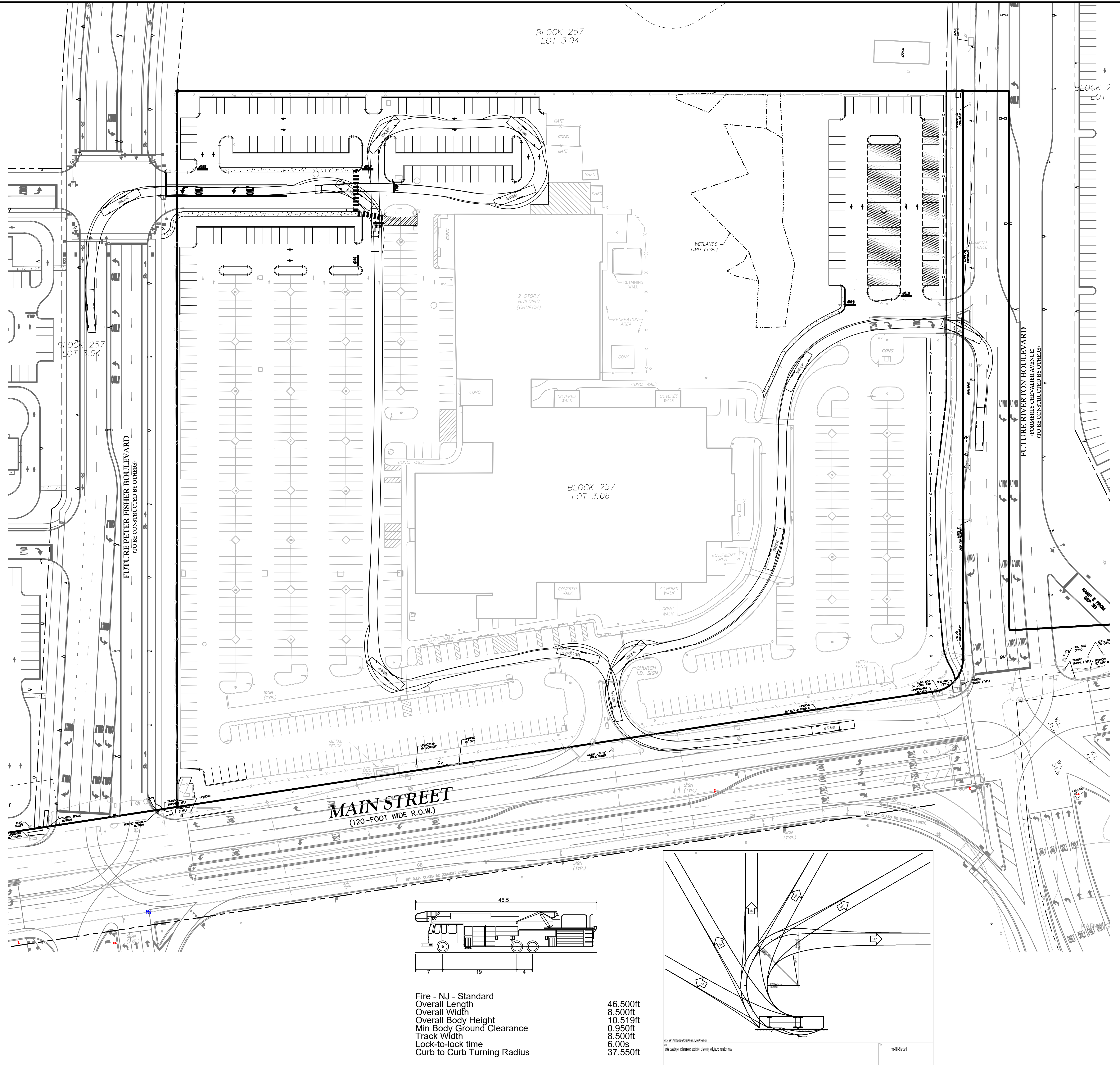
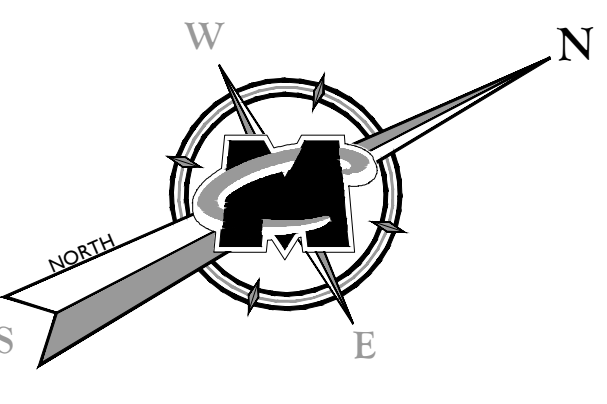

Fire - NJ - Standard  
Overall Length 46.500ft  
Overall Width 8.500ft  
Overall Body Height 10.519ft  
Min Body Ground Clearance 0.950ft  
Track Width 8.500ft  
Lock-to-lock time 6.00s  
Curb to Curb Turning Radius 37.550ft

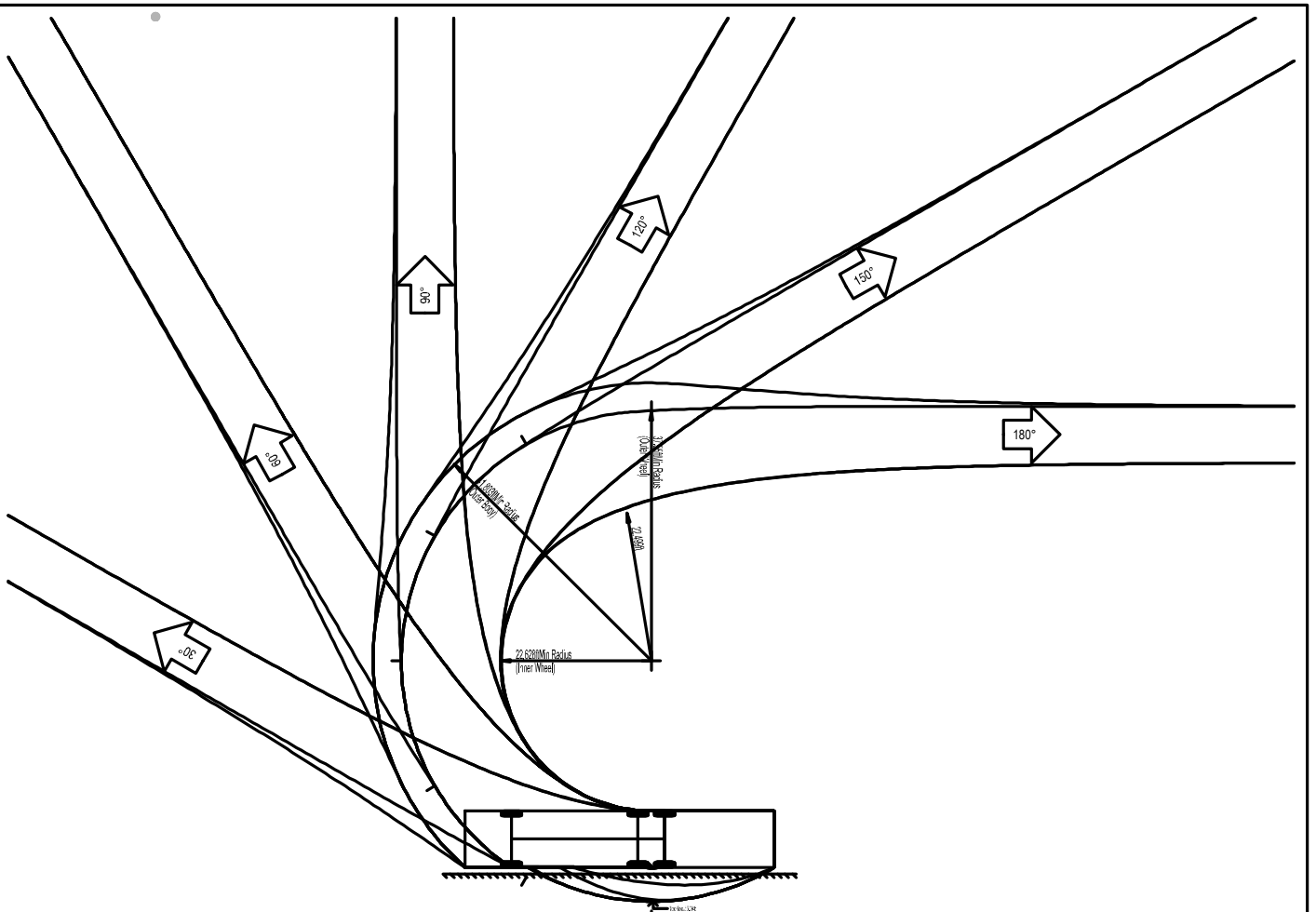

REV	DATE	DRAWN BY	DESCRIPTION

REV	DATE	DRAWN BY	DESCRIPTION



Daniel W. Busch  
NEW JERSEY LICENSED PROFESSIONAL ENGINEER  
LICENSE NUMBER: GE42093  
MASER CONSULTING, INC.  
NJ C.O.A. # 2463798650

VEHICLE CIRCULATION PLAN  
FOR  
EPIC CHURCH

BLOCK 257  
LOT 3.06  
TAX MAP SHEET 91

BOROUGH OF SAYREVILLE  
MIDDLESEX COUNTY  
NEW JERSEY

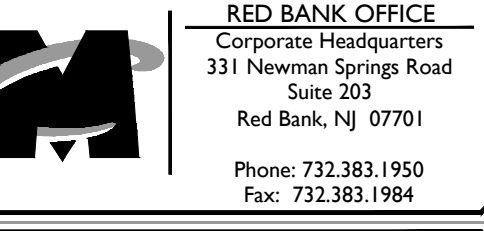

RED BANK OFFICE  
Corporate Headquarters  
311 Newman Springs Road  
Suite 203  
Red Bank, NJ 07701  
Phone: 732.383.1950  
Fax: 732.383.1984

SCALE	DATE	DRAWN BY	CHECKED BY
AS SHOWN	4/9/2021	RM	DB
PROJECT NUMBER	DRAWING NAME		
0500500F	C-CIRC-CHURCH		

SHEET TITLE  
CIRCULATION PLAN  
FIRE TRUCK

NOTE: DO NOT SCALE DRAWINGS FOR CONSTRUCTION.



